

**Section A**  
Answer **all** questions in this section.

**A1** A logo for an internet café is shown below.

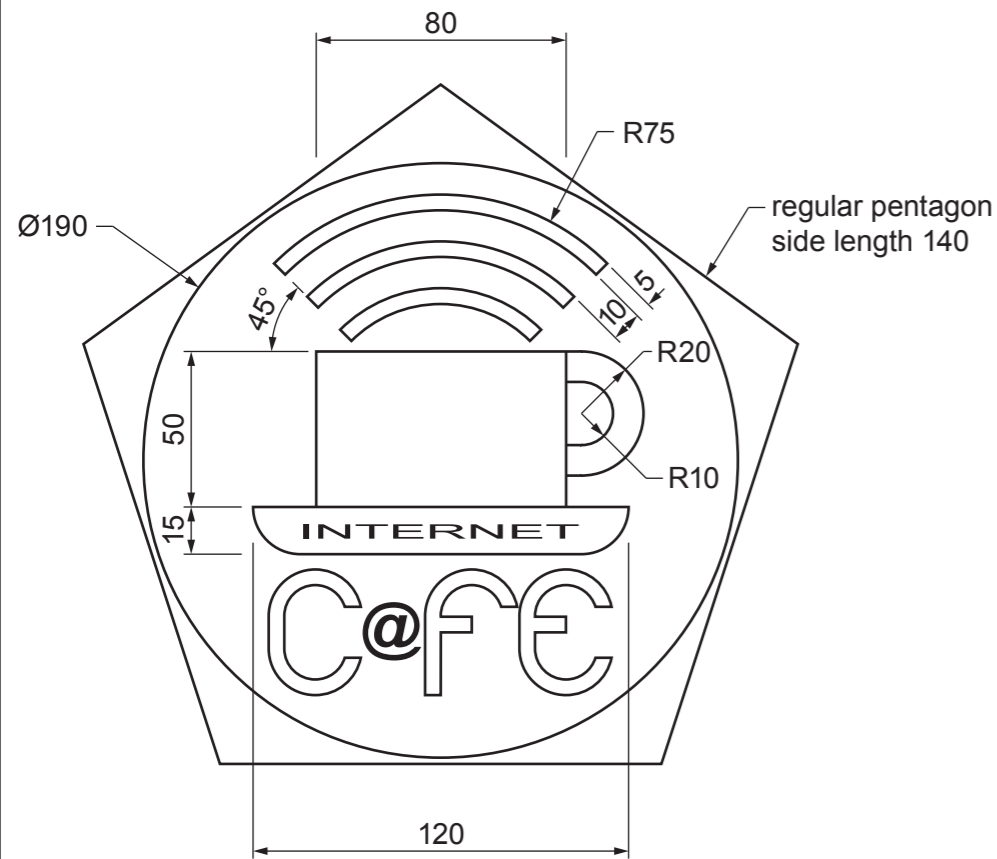

Complete the full-size drawing of the internet café logo by adding:

- (a) the cup and saucer [5]
- (b) the wifi arcs [4]
- (c) the circle [1]
- (d) the outer pentagon [3]
- (e) the C@FE lettering. [4]

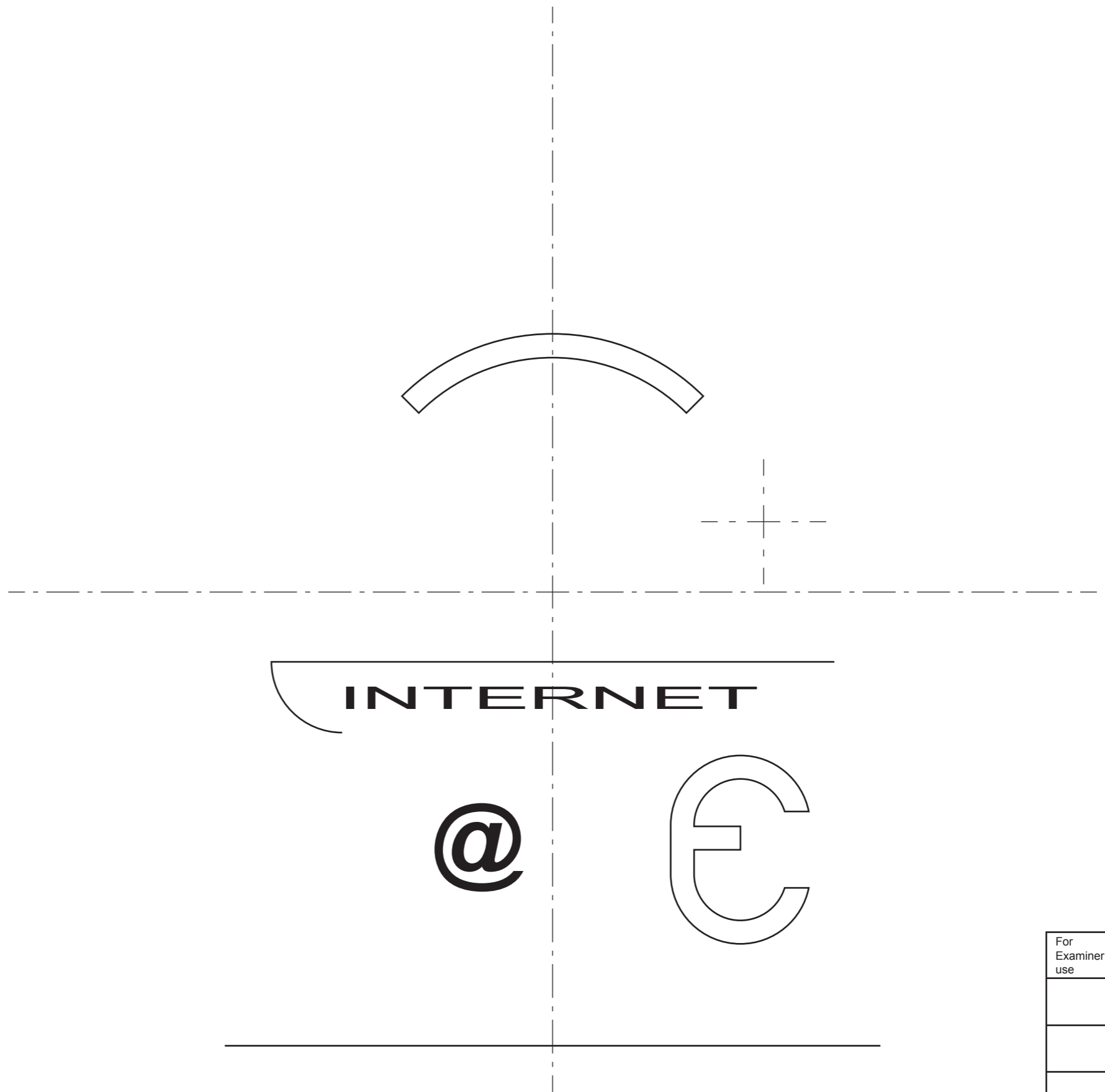

For Examiner's use

**A2** A coffee cup from the internet café is shown to the right.

Complete the coffee cup by adding the top ellipse.

Major axis 150. Minor axis 78.

[6]

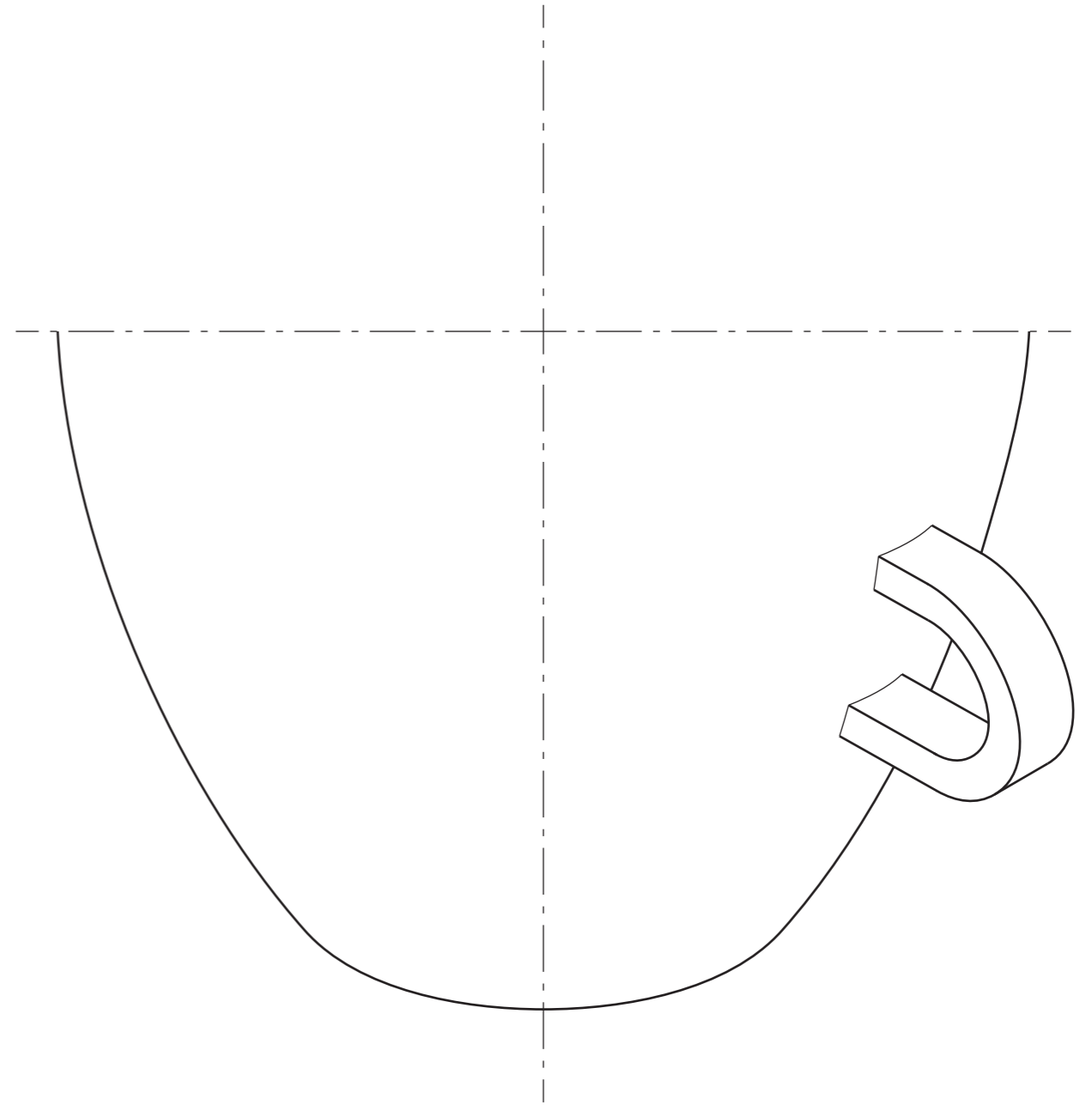

**A3** A design for a coffee cup coaster to be used in the internet café is shown below.

Each coffee cup coaster will be made from 5 mm thick acrylic sheet

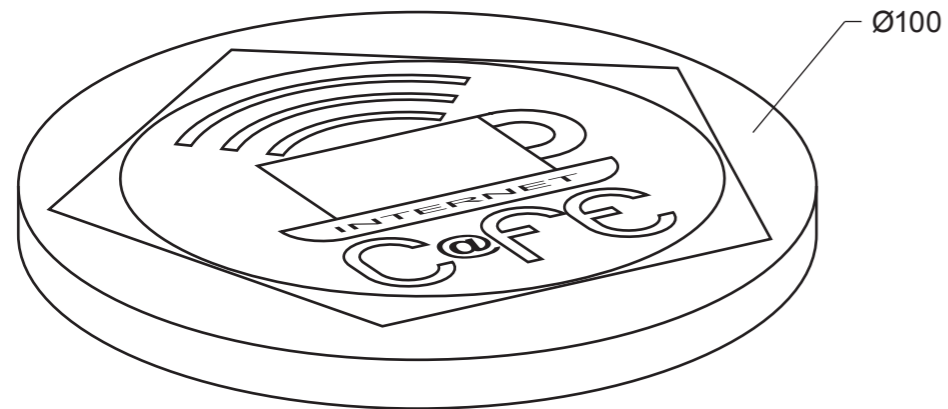

The coffee cup coasters will be produced in batches of 100 using CAD/CAM.

(a) Name **one** piece of CAM equipment that could be used to produce the batch of coffee cup coasters.

..... [1]

(b) State **one** property of acrylic that makes it suitable for the coffee cup coasters.

..... [1]

**Section B**

Answer **one** question, **either** question **B4** or **B5**, from this section.

**B4** Isometric views of a design for a menu holder are shown below.

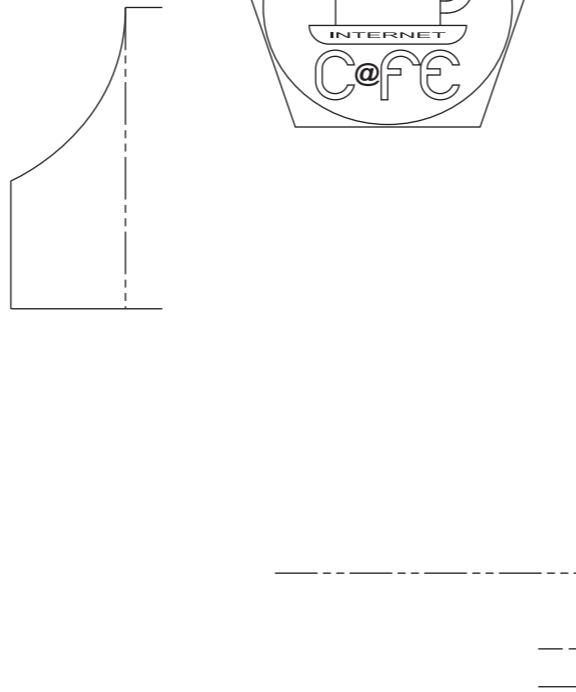
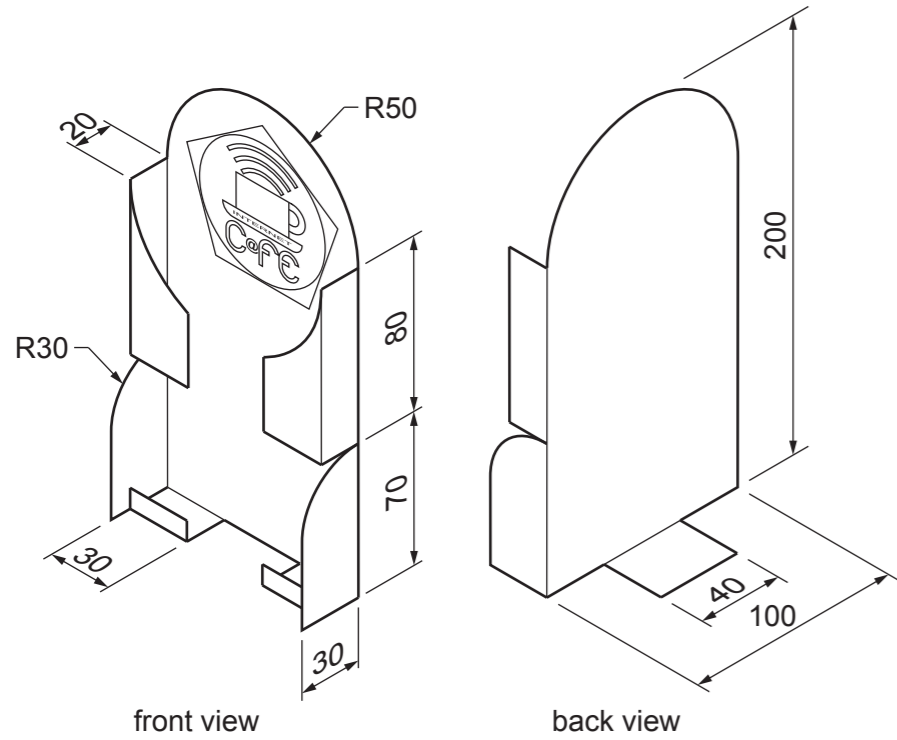

development (net)

(a) Complete the development (net) of the menu holder to a scale of 1:2. [12]

(b) A model of the menu holder is to be made from thin card.

(i) Complete the table to show the processes and tools/items of equipment that would be used to make the model of the menu holder.

Process	Tools/items of equipment
Marking out the development (net) onto thin card	
Cutting out the development (net)	
Scoring the fold lines	

[3]

(ii) The final menu holder will be made from thin plastic sheet.

Explain how the development (net) made from thin plastic sheet could be bent to shape.

.....

.....

..... [2]

(c) An alternative design for a menu holder is shown below.

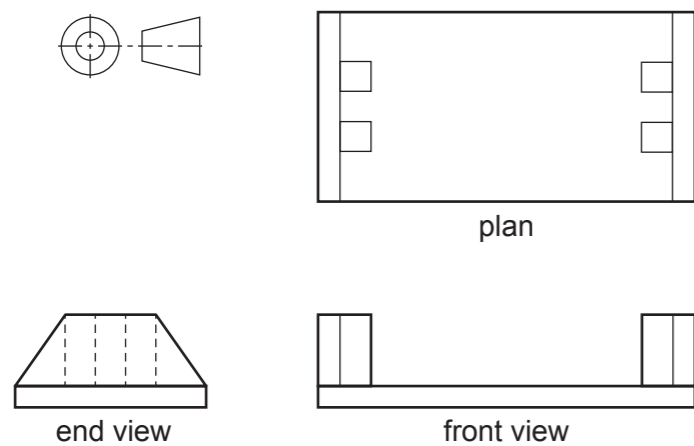

Complete the estimated two-point perspective view of the menu holder. [8]

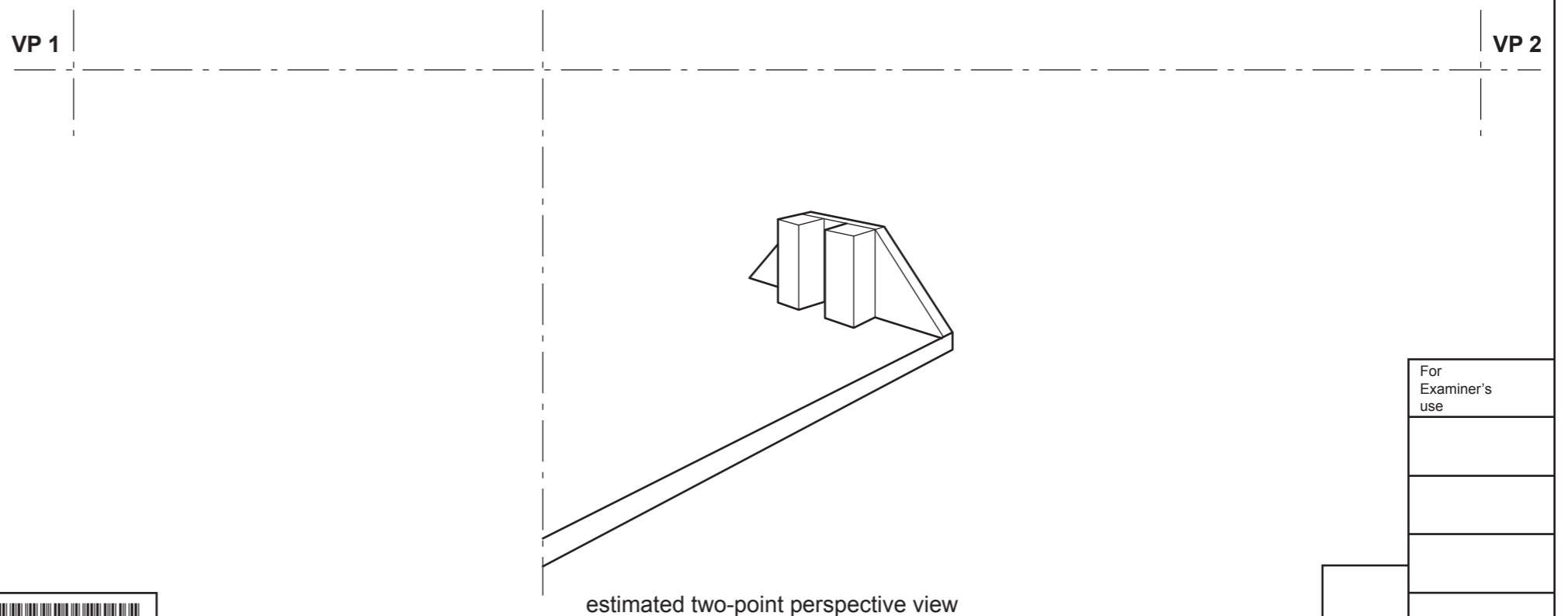

estimated two-point perspective view



**B5** A chair used in the internet café is shown below.

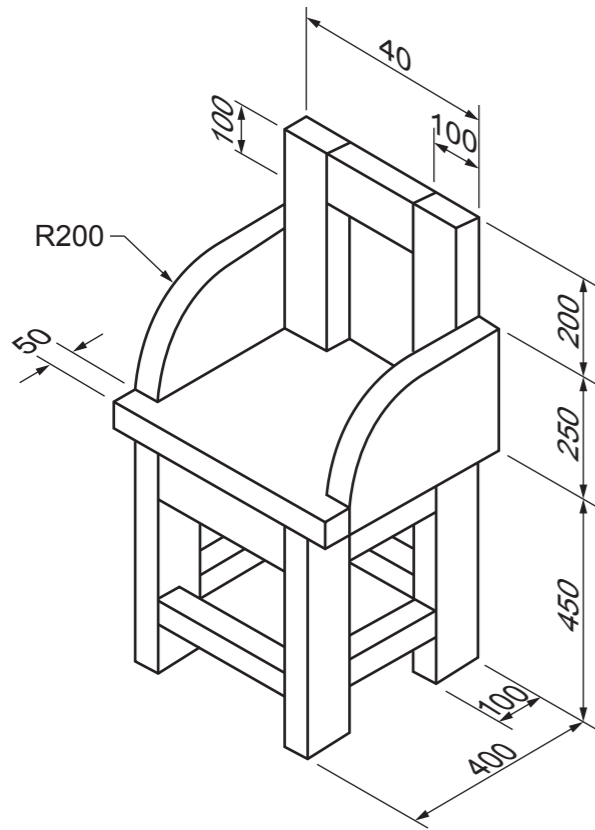

plan

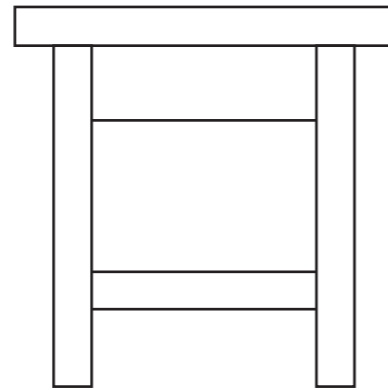
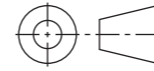

front view



side view

(a) Complete the orthographic views of the chair to a scale of 1 : 10. [12]

(b) A condiment holder and condiment container used in the internet café are shown below.

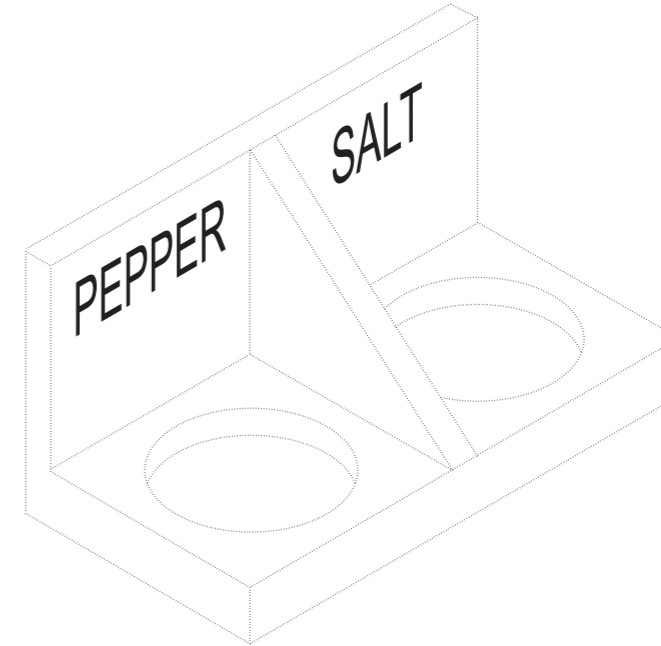

condiment holder

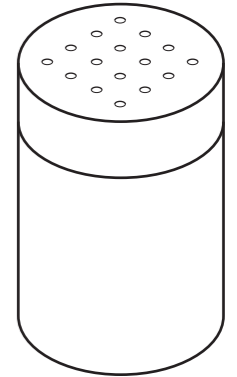

condiment container

- (i) Apply thick and thin line technique to the condiment holder. [3]
- (ii) Render the condiment container to look like it is made from stainless steel. [3]

(d) The three parts of the condiment holder will be joined together using adhesive. A symbol on the adhesive bottle is shown below.

State the meaning of the symbol.



..... [1]

(c) The condiment holder will be made from three pieces of hardwood as shown below.

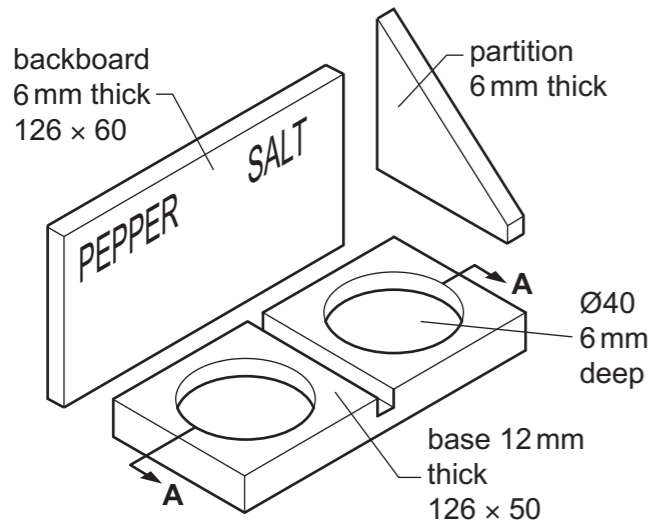

sectional view A-A

Complete the full-size sectional view A-A through the base of the condiment holder. [5]

(e) The SALT and PEPPER lettering will be cut from self-adhesive vinyl and then applied to the condiment holder.

State **one** benefit, other than being quicker, of using CAD/CAM to produce the lettering compared to cutting the lettering by hand.

..... [1]